

# THE CAROLINE

A TIMELESS CLASSIC

**SUITE FEATURES**  
 1,350 SF 1 bedroom duplex residence  
 440 SF private terrace

Master bathroom and powder room. 5 closets  
 Living room and dining area open to terrace

**PRIVATE TERRACE**  
 • 440 SF, planter boxes, Viking grill and sconced exterior lighting

**MASTER BEDROOM SUITE**

- 16' 2" x 15' 4" master bedroom with private entrance, floor-to-ceiling windows, and three large closets including a custom Birch walk-in-closet
- Master bath with floor-to-ceiling window, Borneo Beige marble mosaic frieze, his and hers sinks, Jacuzzi, frameless glass walk-in-shower, Waterworks fixtures

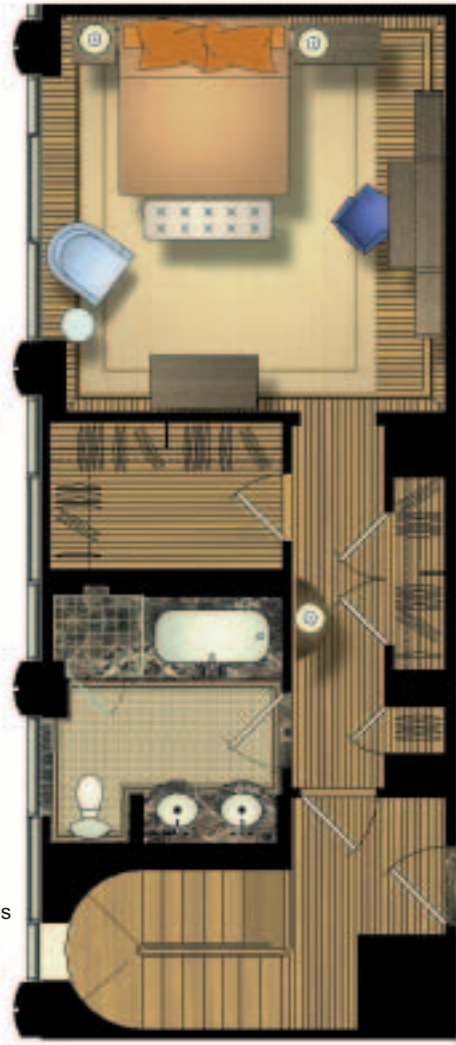

- Custom Brazilian cherry flooring with inlaid mahogany borders
- Crown moldings and solar shades throughout
- Interior architect's suggested furniture plan.

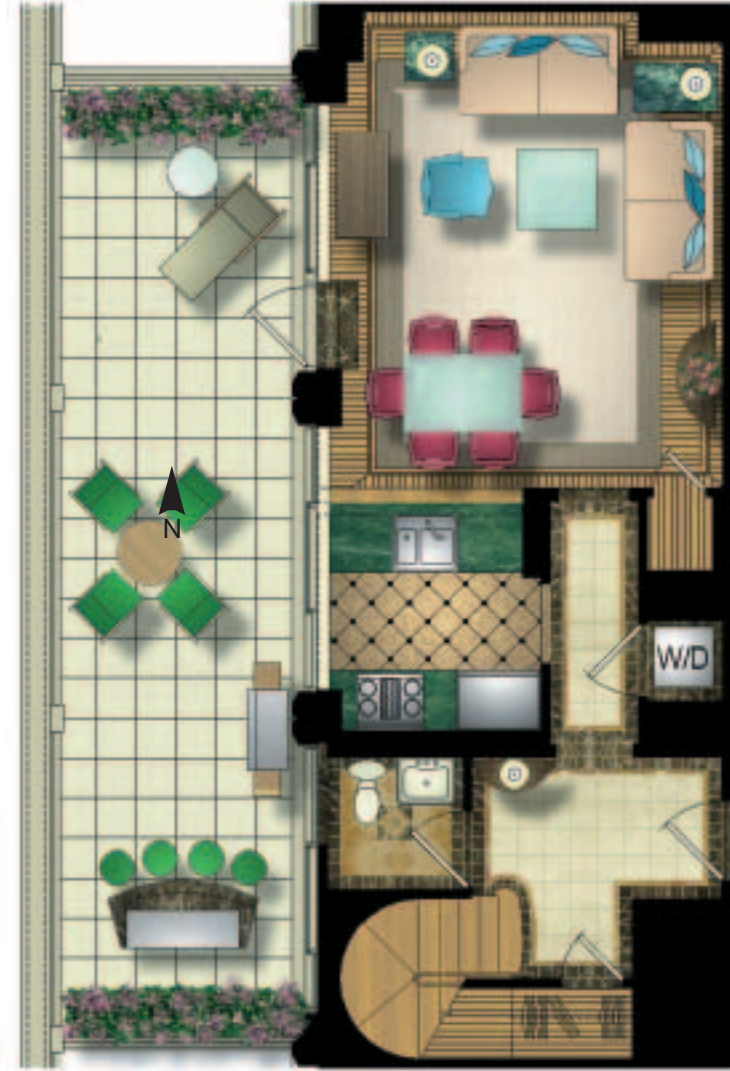

**LIVING ROOM**  
 • 18' 4" x 16' living room and dining area open to terrace

**KITCHEN**

- Giallo Veneziano granite and Noir Saint-Laurent marble floor, Uba Tuba granite countertops and pass thru, Viking stove, Sub-Zero refrigerator with filtered ice water, Sub-Zero wine cooler, Miele dishwasher and washer/ dryer, InSinkerator

**ENTRY GALLERY**

- Inlaid Botticino Classico marble foyer and entry gallery
- Coat closet with custom Birch interior
- Cappuccino Onyx marble powder room



**PENTHOUSE 21A**  
 60 West 23rd Street, New York, NY 10010

All furniture is for design only and not included. All dimensions are approximate and subject to normal construction variances.

